



2/20 Croydon Street CRONULLA NSW

2 1 1

Perfectly presented and offering unbeatable convenience to the heart of Cronulla and beaches, this tastefully appointed apartment is just a brief level stroll to an array of transport options, restaurants, shopping and entertainment.

Price : \$ 350,000

View : <https://www.paynepacific.com.au/sale/nsw/sutherland/cronulla/residential/apartment/5873105>

Found within a small security building, it presents the perfect first purchase or investment, with not a cent more to spend. Its also ideal for those downsizing, with only a few steps up to its front door.

The stylish open-plan kitchen features a breakfast bar, dishwasher and a servery through to the bright living and dining area, enhancing the sense of space and light. It opens to a sunny balcony for alfresco dining.

Accommodation comprises two double bedrooms, the main with an entire wall of mirrored built-in robes, a smart

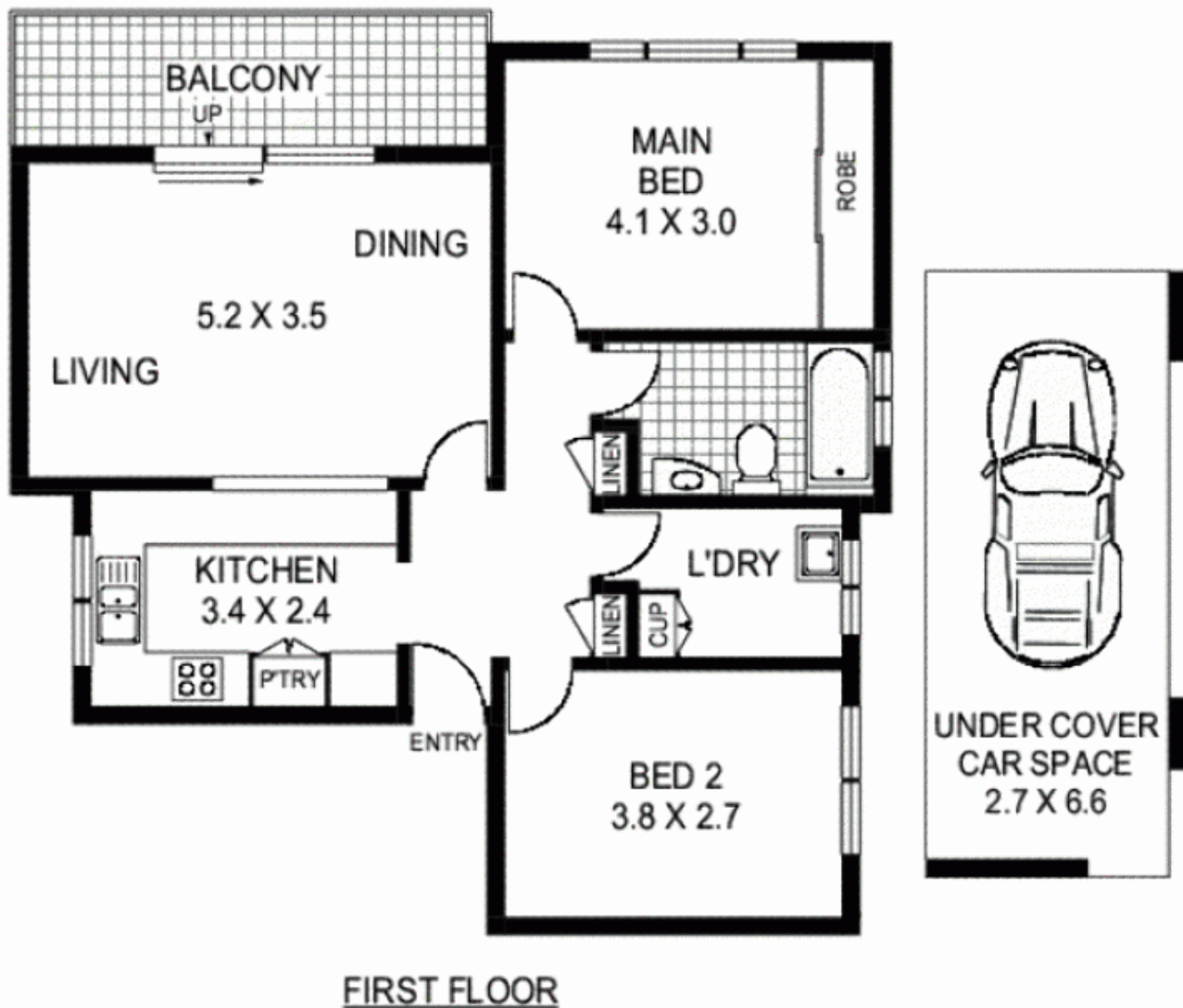

NOTE : UNDER COVER CAR SPACE AVAILABLE



2/20 CROYDON STREET

CRONULLA



Floor Plan Disclaimer: Mind the Gap (mtg) floor plans / site plans are intended as a guide only. No representations or warranties of any nature whatsoever are given or intended and any person using this information should always rely on their own enquiries. mtg property marketing services - 1300 133 145 - photography, floor plans, virtual tours, video tours, copywriting, project marketing - www.mindthegap.com.au

Payne Pacific Real Estate gives no guarantees or warranties concerning the accuracy or completeness of the information provided, and accepts no liability for any loss or damage suffered as a result of the use by any person of the contents of this document. It may not be reproduced by any process, electronic or otherwise, in any form, without the prior written permission of Payne Pacific Real Estate, except as permitted under the Copyright Act 1968.